

# HEATING TANK

Pressure vessel with double jacket

## Material

1.4404 (316L)

## Finishing

stained in the bath or electropolished inside and outside

## Volumes

0.1 to 1,000 liters (see type overview)

## Gaskets

PTFE, chambered

## Pressure

-1/ 5 bar

## Equipment

Central flange with:

- OUT Immersion tube with tube fitting
- GAS pipe fitting

Above cylindrical part and bottom:

- DOUBLE MANTLE



Type	Material	Finishing	Volume [l]	Ø Da [mm]	H [mm]	s [mm]	Mass [kg]	Pressure [bar]
JED 0.25	1.4404 (316L)	stained	0,3	67	160	1	1,5	-1/+5
JED 0.5	1.4404 (316L)	stained	0,6	89	190	1	2	-1/+5
JED 01	1.4404 (316L)	stained	1,3	108	230	1	2,5	-1/+5
JED 02	1.4404 (316L)	stained	3	140	300	1	4	-1/+5
JED 05	1.4404 (316L)	stained	6	181	350	1	6	-1/+5
NED 10	1.4404 (316L)	stained	12	229	460	1,5	10	-1/+5
NED 20	1.4404 (316L)	stained	23	278	550	1,5	12	-1/+5
NED 30	1.4404 (316L)	stained	33	324	610	1,5	14	-1/+5
NED 50	1.4404 (316L)	stained	53	363	675	1,5	16	-1/+5
HED 100	1.4404 (316L)	stained	110	450	960	2	30	-1/+4
MED150	1.4404 (316L)	stained	160	550	950	2,5	40	-1/+4
HED 200	1.4404 (316L)	stained	205	600	1050	2	56	-1/+4

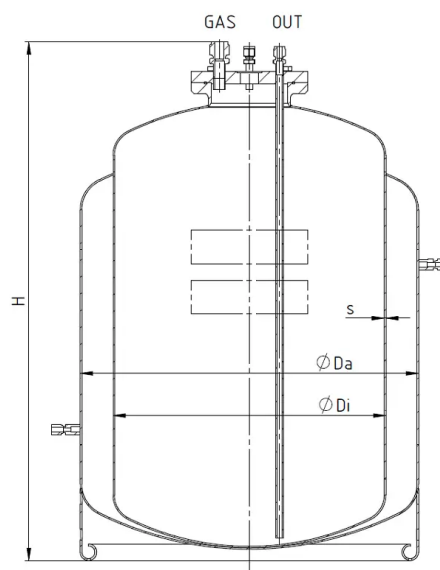

*Safety for people, product and the environment*



Dipl.-Ing. Wilhelm Schmidt GmbH

Breslauer Str. 14

64342 Seeheim-Jugenheim

Germany

+49 6257 50 69 0

+49 6257 50 69 50

info@schmidt-seeheim.de

www.schmidt-seeheim.com